

# Parts List for Model 6116783-02C/-02CSC

## Ku Tx/Rx Feed/OMT-Filter Assembly

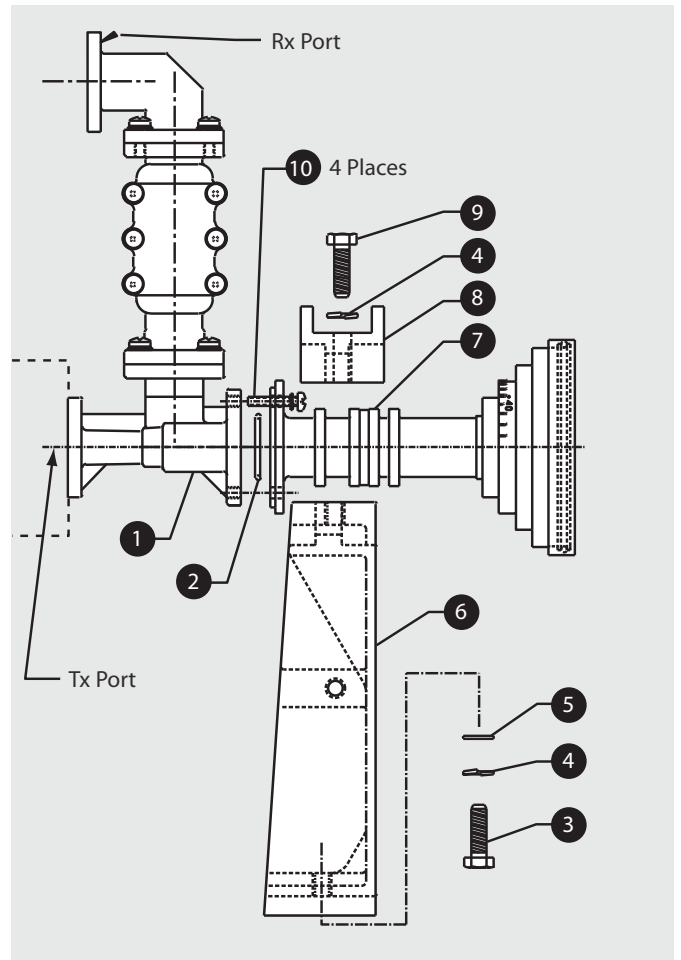
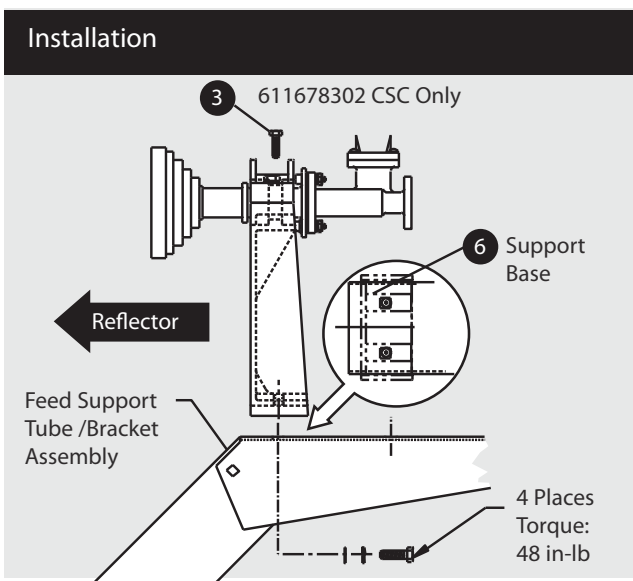
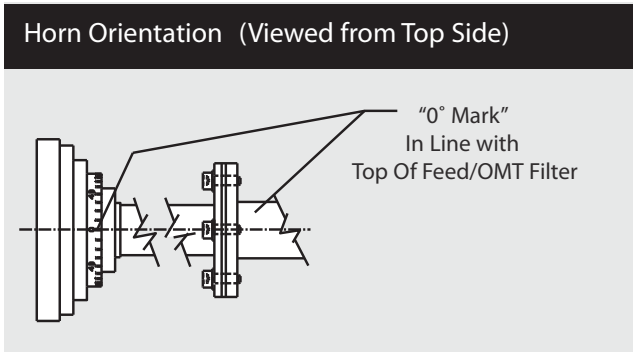

### Parts List - Ku-band Tx/Rx Feed/OMT-Filter Assembly with Mounting Block

NO	QTY	NO	QTY	NO	QTY
1	1	5	2	9	2
2	1	6	1	10	4
3	2	7	1		
4	4	8	1		

**Notes:**

Assemble LNB to Rx Port and BUC to Tx Port  
 Use O-rings supplied with BUC & LNB  
 Tighten BUC & LNB Hardware fully per manufacturers recommendations



**DO NOT DISCARD CONTENTS**

The product in this packaging was placed in the market after August 13, 2005. Its components must not be discarded with normal municipal or household waste. Contact your local waste disposal agency for recovery, recycling, or disposal instructions.



## PERIODIC INSPECTION & MAINTENANCE

To ensure peak performance of the antenna system and to maintain validity of the warranty, the user should perform a periodic inspection every 6 months or following any severe weather event, As a minimum the following items should be inspected.

### 1. Installation Mount

Check for loose hardware - tighten if necessary.

Check integrity of anchor bolts or hardware securing mount to the building or foundations

Check ballast of Non-Penetrating Roof Mounts - cracked or broken blocks must be replaced.

Check hardware and structural members for signs of corrosion - repair or replace as needed

### 2. Antenna Back Structure or Az/El Mount

Check for loose hardware - tighten if necessary.

Check for signs of structural damage such as bending or cracking

Check hardware and structural members for signs of corrosion - repair or replace as needed

### 3. Reflector

Check integrity of bolts securing reflector to back structure or az/el mount. Tighten any loose hardware.

Check for signs of damage such as cracking. Inspect reflector face for impact damage.

Check hardware for signs of corrosion - repair or replace as needed.

### 4. Feed Support Structure

Check for loose hardware - tighten if necessary.

Check for signs of structural damage such as bending. Check hardware and structural members for signs of corrosion - repair or replace as needed

### 5. Feed & RF Components

Check for loose hardware - tighten if necessary.

Check hardware for signs of corrosion - repair or replace as needed.

Check feed lens or window for damage or signs of leaking.

Check waveguide connections between feed and RF electronics

### 6. Electrical

Check for loose cables and connectors - tighten if necessary

Check for tight grounding connections

Check cables for weathering or cracks